

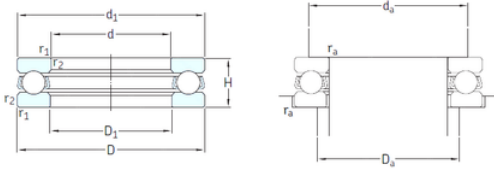

# BEARING DRIVESHAFT, INC.

## skf 51108 bearing

Bearing No. 51108



51108 Bearing 2D drawings and 3D CAD models

Size	40x60x13 mm
Bore Diameter	40 mm
Outer Diameter	60 mm
Width	13 mm
d	40 mm
D	60 mm
H	13 mm
d1	60 mm
r1 min.	0,6 mm
r2 min.	0,6 mm
D1	42 mm
da min.	52 mm
Da max.	48 mm
ra max.	0,6 mm
Weight	0,12 Kg
Basic dynamic load rating (C)	25,5 kN
Basic static load rating (C0)	63 kN
Fatigue load limit (Pu)	2,32
Reference speed	5000 r/min
Limiting speed	7000 r/min
Category	Thrust Ball Bearing
Inventory	0.0
Manufacturer Name	SKF
Minimum Buy Quantity	N/A
Weight / Kilogram	0.128
EAN	7316577058614



## BEARING DRIVESHAFT, INC.

Product Group	B00308
Rolling Element	Ball Bearing
Thrust Bearing	Yes
Single or Double Direction	Single Direction
Banded	No
Cage Material	Steel
Precision Class	ABEC 1   ISO P0
Component Description	Roller Assembly Plus Raceways
Other Features	Single Row
Long Description	40MM Bore 1; 42MM Bore 2; 60MM Outside Diameter; 13MM Height; Ball Bearing; Single Direction; Not Banded; Steel Cage; ABEC 1   ISO P0 Precision
Inch - Metric	Metric
Category	Thrust Ball Bearings
UNSPSC	31171507
Harmonized Tariff Code	8482.10.50.08
Noun	Bearing
Keyword String	Ball Thrust
Manufacturer URL	<a href="http://www.skf.com">http://www.skf.com</a>
Manufacturer Item Number	51108
Weight / LBS	0.283
Height	0.512 Inch   13 Millimeter
Bore 2	1.654 Inch   42 Millimeter
Overall Height with Aligning Washer	0 Inch   0 Millimeter
Bore 1	1.575 Inch   40 Millimeter
Outside Diameter	2.362 Inch   60 Millimeter
bore diameter:	40 mm
static load capacity:	63 kN
outside diameter:	60 mm



## BEARING DRIVESHAFT, INC.

dynamic load capacity:	25.5 kN
overall width:	13 mm
maximum rpm:	7000 RPM
thrust bearing type:	Single-Direction
cage material:	Steel
outside diameter design:	Straight
fillet radius:	0.6 mm
separable or banded:	Separable
series:	511
precision rating:	ABEC 1 (ISO Class Normal)
$d_1$	60 mm
$D_1$	42 mm
$r_{1,2}$ min.	0.6 mm
$d_a$ min.	52 mm
$D_a$ max.	48 mm
$r_a$ max.	0.6 mm
Basic dynamic load rating C	25.5 kN
Basic static load rating $C_0$	63 kN
Fatigue load limit $P_u$	2.32 kN
Minimum load factor A	0.02
Mass bearing (including seat washer where applicable)	0.12 kg