

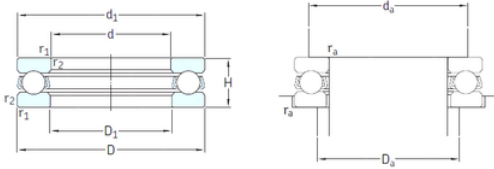

# BEARING DRIVESHAFT, INC.

## skf 51203 bearing

Bearing No. 51203



51203 Bearing 2D drawings and 3D CAD models

Size	17x35x12 mm
Bore Diameter	17 mm
Outer Diameter	35 mm
Width	12 mm
d	17 mm
D	35 mm
H	12 mm
d1	35 mm
r1 min.	0,6 mm
r2 min.	0,6 mm
D1	19 mm
da min.	28 mm
Da max.	24 mm
ra max.	0,6 mm
Weight	0,053 Kg
Basic dynamic load rating (C)	16,3 kN
Basic static load rating (C0)	27 kN
Fatigue load limit (Pu)	1
Reference speed	6700 r/min
Limiting speed	9500 r/min
Category	Thrust Ball Bearing
Inventory	0.0
Manufacturer Name	SKF
Minimum Buy Quantity	N/A
Weight / Kilogram	0.055
Product Group	B00308



## BEARING DRIVESHAFT, INC.

Rolling Element	Ball Bearing
Thrust Bearing	Yes
Single or Double Direction	Single Direction
Banded	No
Cage Material	Steel
Precision Class	ABEC 1   ISO P0
Component Description	Roller Assembly Plus Raceways
Other Features	Single Row
Long Description	17MM Bore 1; 19MM Bore 2; 35MM Outside Diameter; 12MM Height; Ball Bearing; Single Direction; Not Banded; Steel Cage; ABEC 1   ISO P0 Precision
Inch - Metric	Metric
Category	Thrust Ball Bearings
UNSPSC	31171507
Harmonized Tariff Code	8482.10.50.08
Noun	Bearing
Keyword String	Ball Thrust
Manufacturer URL	<a href="http://www.skf.com">http://www.skf.com</a>
Manufacturer Item Number	51203
Weight / LBS	0.121
Outside Diameter	1.378 Inch   35 Millimeter
Bore 2	0.748 Inch   19 Millimeter
Height	0.472 Inch   12 Millimeter
Bore 1	0.669 Inch   17 Millimeter
Overall Height with Aligning Washer	0 Inch   0 Millimeter
bore diameter:	17 mm
static load capacity:	27 kN
outside diameter:	35 mm
dynamic load capacity:	16.3 kN



## BEARING DRIVESHAFT, INC.

overall width:	12 mm
maximum rpm:	9500 RPM
thrust bearing type:	Single-Direction
cage material:	Steel
outside diameter design:	Straight
fillet radius:	0.6 mm
separable or banded:	Separable
series:	512
precision rating:	ABEC 1 (ISO Class Normal)
$d_1$	35 mm
$D_1$	19 mm
$r_{1,2}$ min.	0.6 mm
$d_a$ min.	28 mm
$D_a$ max.	24 mm
$r_a$ max.	0.6 mm
Basic dynamic load rating C	16.3 kN
Basic static load rating $C_0$	27 kN
Fatigue load limit $P_u$	1 kN
Minimum load factor A	0.0047
Mass bearing (including seat washer where applicable)	0.053 kg