

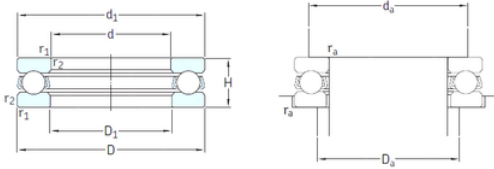

# BEARING DRIVESHAFT, INC.

## skf 51120 bearing

Bearing No. 51120



51120 Bearing 2D drawings and 3D CAD models

Size	100x135x25 mm
Bore Diameter	100 mm
Outer Diameter	135 mm
Width	25 mm
d	100 mm
D	135 mm
H	25 mm
d1	135 mm
r1 min.	1 mm
r2 min.	1 mm
D1	102 mm
da min.	121 mm
Da max.	114 mm
ra max.	1 mm
Weight	0,97 Kg
Basic dynamic load rating (C)	80,6 kN
Basic static load rating (C0)	265 kN
Fatigue load limit (Pu)	9,15
Reference speed	2400 r/min
Limiting speed	3200 r/min
Category	Thrust Ball Bearing
Inventory	0.0
Manufacturer Name	SKF
Minimum Buy Quantity	N/A
Weight / Kilogram	0.999
EAN	7316577006554



## BEARING DRIVESHAFT, INC.

Product Group	B00308
Rolling Element	Ball Bearing
Thrust Bearing	Yes
Single or Double Direction	Single Direction
Banded	No
Cage Material	Steel
Precision Class	ABEC 1   ISO P0
Component Description	Roller Assembly Plus Raceways
Other Features	Single Row
Long Description	100MM Bore 1; 102MM Bore 2; 135MM Outside Diameter; 25MM Height; Ball Bearing; Single Direction; Not Banded; Steel Cage; ABEC 1   ISO P0 Precision
Inch - Metric	Metric
Category	Thrust Ball Bearings
UNSPSC	31171507
Harmonized Tariff Code	8482.10.50.08
Noun	Bearing
Keyword String	Ball Thrust
Manufacturer URL	<a href="http://www.skf.com">http://www.skf.com</a>
Manufacturer Item Number	51120
Weight / LBS	2.2
Outside Diameter	5.315 Inch   135 Millimeter
Height	0.984 Inch   25 Millimeter
Overall Height with Aligning Washer	0 Inch   0 Millimeter
Bore 1	3.937 Inch   100 Millimeter
Bore 2	4.016 Inch   102 Millimeter
bore diameter:	100 mm
static load capacity:	265 kN



## BEARING DRIVESHAFT, INC.

outside diameter:	135 mm
dynamic load capacity:	80.6 kN
overall width:	25 mm
maximum rpm:	3200 RPM
thrust bearing type:	Single-Direction
cage material:	Steel
outside diameter design:	Straight
fillet radius:	1 mm
separable or banded:	Separable
series:	511
precision rating:	ABEC 1 (ISO Class Normal)
$d_1$	135 mm
$D_1$	102 mm
$r_{1,2}$ min.	1 mm
$d_a$ min.	121 mm
$D_a$ max.	114 mm
$r_a$ max.	1 mm
Basic dynamic load rating C	80.6 kN
Basic static load rating $C_0$	265 kN
Fatigue load limit $P_u$	9.15 kN
Minimum load factor A	0.44
Mass bearing (including seat washer where applicable)	0.97 kg