

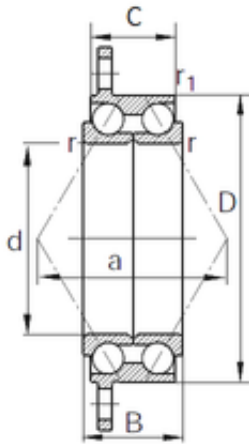

BEARING DRIVESHAFT, INC.

52 mm x 78 mm x 27.2 mm KBC SDA0106
angular contact ball bearings



Bearing No. SDA0106

Size	52x78x27.2 mm
Bore Diameter	52 mm
Outer Diameter	78 mm
Width	27.2 mm
d	52 mm
D	78 mm
B	27.2 mm
C	23 mm
Angle (°)	30 °
a	51 mm
r min.	1.1 mm
r1 min.	0.7 mm
Basic dynamic load rating (C)	43,5 kN

SDA0106 Bearing 2D drawings and 3D CAD models