

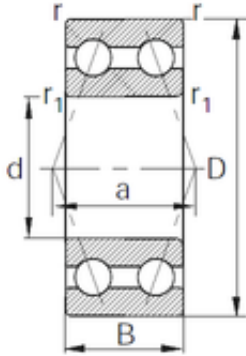

BEARING DRIVESHAFT, INC.

30 mm x 55 mm x 23 mm KBC SDA9101 DDY2
angular contact ball bearings



Bearing No. SDA9101 DDY2

Size	30x55x23 mm
Bore Diameter	30 mm
Outer Diameter	55 mm
Width	23 mm
d	30 mm
D	55 mm
B	23 mm
C	23 mm
a	28.8 mm
r min.	0.6 mm
r1 min.	0.6 mm
Basic dynamic load rating (C)	19,7 kN

SDA9101 DDY2 Bearing 2D drawings and 3D CAD models